



# THE STATE OF GEORGIA

## EXECUTIVE ORDER

---

BY THE GOVERNOR:

- WHEREAS:** The State of Georgia holds title to certain real property by virtue of a June 1, 1948 deed from Charlton County, Georgia for approximately 7.435 acres recorded in Charlton County Clerk of Superior Court in Deed Book 2, Page 498 (the "Property"); and
- WHEREAS:** Said Property is in the custody of the Georgia Forestry Commission; and
- WHEREAS:** Said Property is improved with those facilities and structures which are collectively known as the "Charlton County Unit"; and
- WHEREAS:** Two structures of the Charlton County Unit known as the Truck Barn and Office, identified as the "Garage" and "Office Building", respectively, on Exhibit "A" attached hereto and incorporated herein by reference (the "Structures"), were found by the Georgia Forestry Commission to be of no further use to the commission and hinder the new location of ingress and egress to and from the Property; and
- WHEREAS:** By resolution dated on January 29, 2013, the Georgia Forestry Commission resolved that the Structures be demolished; and
- WHEREAS:** By letter dated January 30, 2013, the Executive Director of the Georgia Forestry Commission requested that the State Properties Commission seek an Executive Order from the Governor to allow for the razing, demolition, and disposal of the Structures; and
- WHEREAS:** The Georgia Forestry Commission has funding available to raze and demolish and dispose of said Structures.

**NOW, THEREFORE, PURSUANT TO THE AUTHORITY VESTED IN ME AS GOVERNOR OF THE STATE OF GEORGIA, IT IS HEREBY**

**ORDERED:**

The Georgia Forestry Commission is hereby authorized and directed to provide for the razing, demolition and disposal of said Structures under the terms and conditions which are deemed to be in the best interests of the State of Georgia.

This 1 day of April, 2013.

*Nathan Deal*

\_\_\_\_\_  
GOVERNOR

**ATTEST:**

*Chris W. Riley*

\_\_\_\_\_  
EXECUTIVE SECRETARY

# EXHIBIT "A"

**OWNER/DEVELOPER**  
**24-HOUR EMERGENCY CONTACT**  
 CONTACT: JERRY ROSE  
 2102 HENDERSON DRIVE  
 CARTERSVILLE, GEORGIA 30120  
 PHONE: 770-279-1822

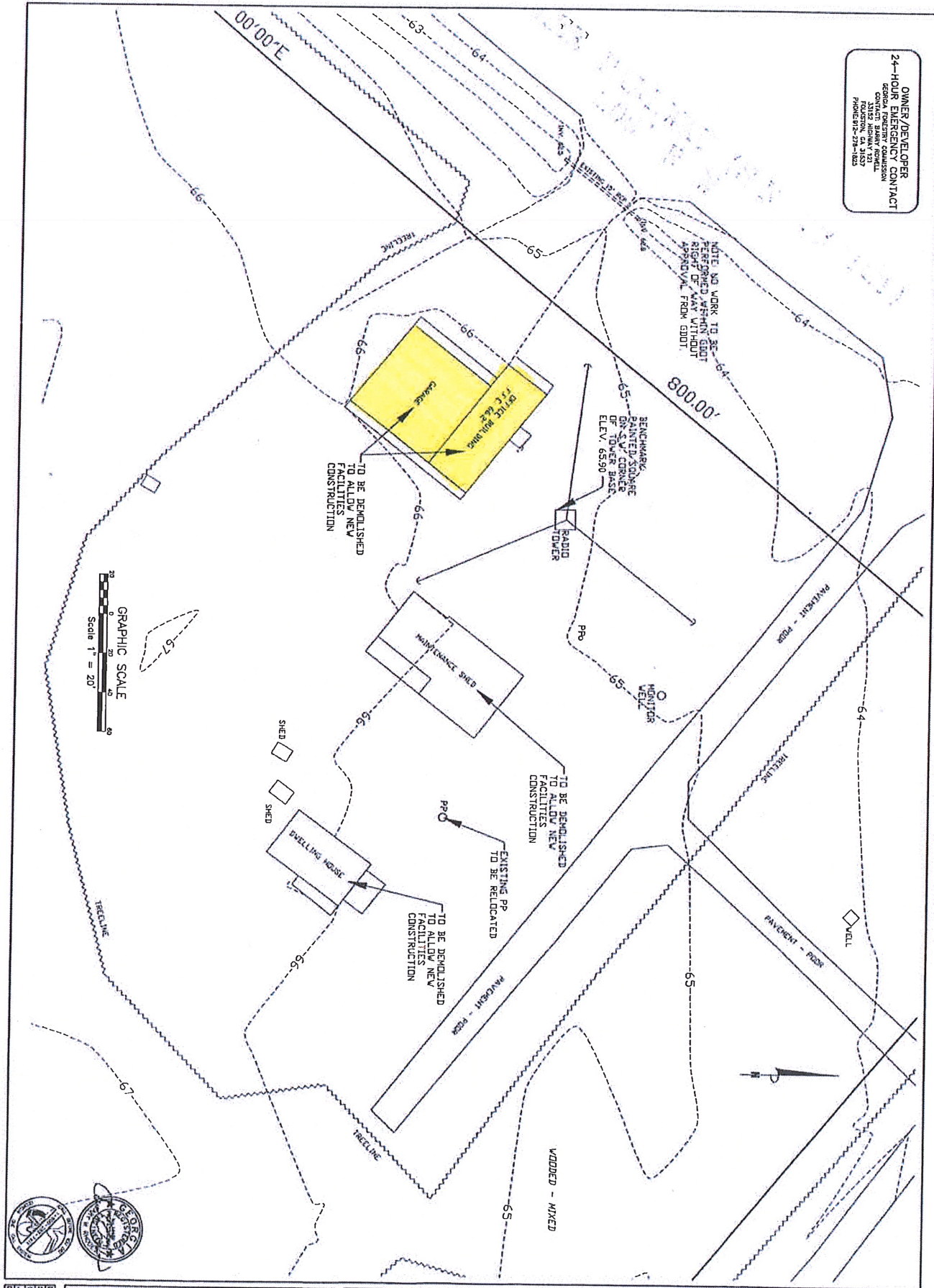

**GRAPHIC SCALE**  
 Scale 1" = 20'

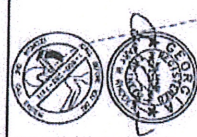

**GEORGIA FORESTRY COMMISSION**  
 OKEFENOKEE PARKWAY (S.R. 23 & 121)  
 LOCATED IN HEADRIGHT AREA 32nd G.M.D.  
 CHARLTON COUNTY, GEORGIA  
**DEMOLITION PLAN**

NO.		DATE	DESCRIPTION

**RHODES ENGINEERING SERVICES, INC.**  
 CIVIL ENGINEERS & LAND SURVEYORS  
 645 HENDERSON DRIVE, SUITE 2  
 CARTERSVILLE, GEORGIA 30120  
 PHONE: 770-386-7616 FAX: 770-386-7617

**1**  
 of 1